

# UNION TOWNSHIP SECTION 30 R 13 TWP 8 MORGAN COUNTY, OHIO

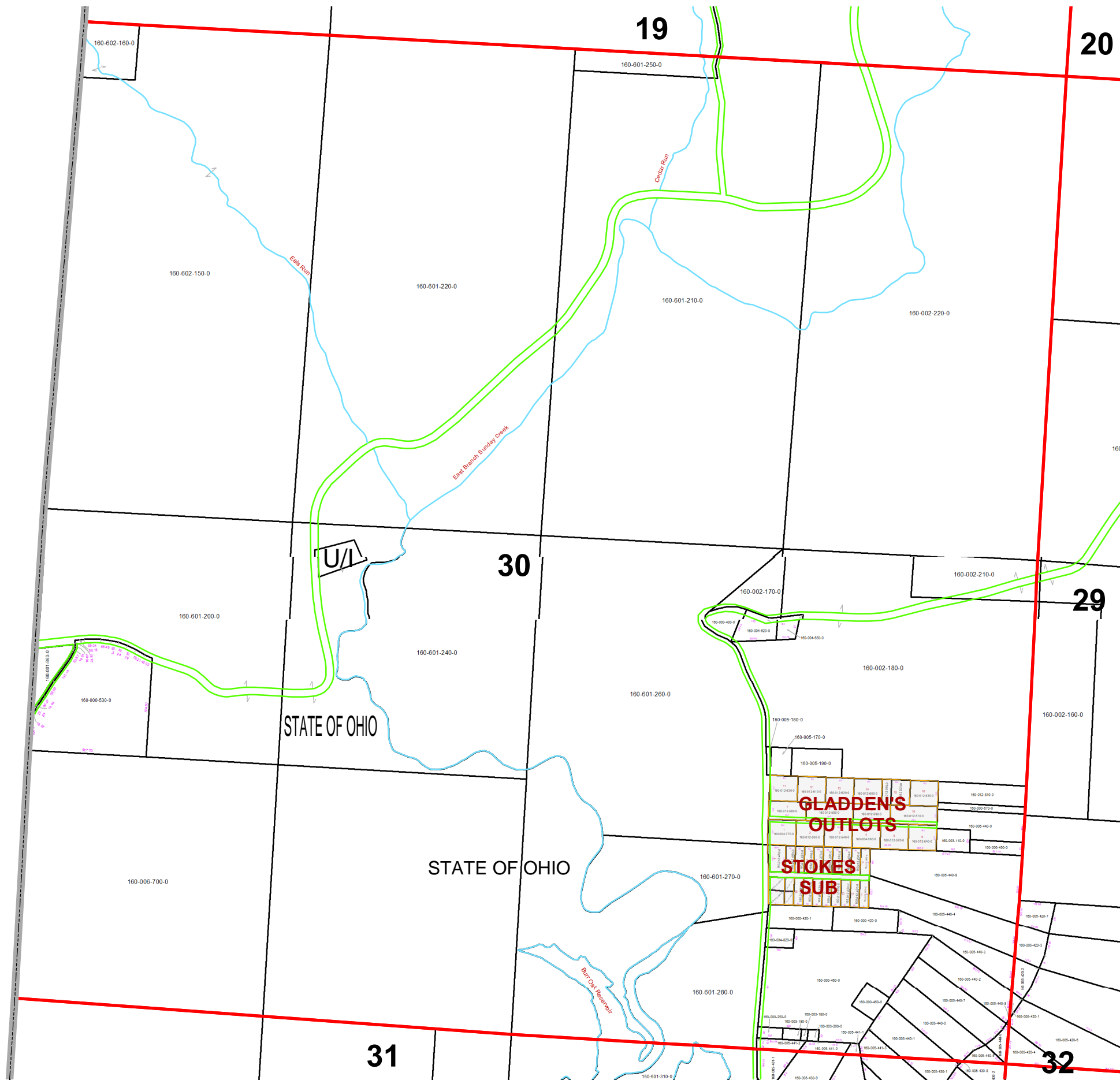

PIN	Owner	LegalDescr	Acres	VOL	PAGE	Survey_Ref
160-000-430-0	ALGUIRE TRACI A & MATTHEW R	R13 T08 S30 SD 35	0.634	OR235	1111	UNN-0353.pdf
160-005-441-0	ALLEN DOUGLAS	R13 T08 S30 SD 62 SUR	0.339	OR232	5580	UNN-0137.pdf
160-005-441-2	ARMSTRONG CARLA	R13 T08 S30 SD 64	0.336	OR118	185	UNN-0137.pdf
160-003-200-0	ARMSTRONG CARLA F	R13 T08 S30 SD 32	0.083	OR4	740	UNN-0142.pdf
160-003-180-0	ARMSTRONG CARLA F	R13 T08 S30 SD 33	0.048	OR4	740	UNN-0142.pdf
160-003-190-0	ARMSTRONG CARLA F	R13 T08 S30 SD 34	0.135	OR4	740	UNN-0142.pdf
160-000-250-0	ARMSTRONG CARLA F	R13 T08 S30 SD 37	0.19	D.V 177	338	NoSurvey.pdf
160-000-450-0	BOND MARY M TRUSTEE	R13 T08 S30 SD 14	0.49	OR214	916	NoSurvey.pdf
160-000-460-0	BOND MARY M TRUSTEE	R13 T08 S30 SD 17	8.59	OR214	916	UNN-0056.pdf
160-005-440-2	BOND MARY M TRUSTEE	R13 T08 S30 SD 54	1.905	OR214	916	UNN-0137.pdf
160-004-820-0	BOND MARY M TRUSTEE	R13 T08 S30 SD 30	0.23	OR214	916	NoSurvey.pdf
160-005-440-3	BOND MARY M TRUSTEE	R13 T08 S30 SD 55	1.67	OR214	916	UNN-0137.pdf
160-000-420-0	BOND MARY M TRUSTEE	R13 T08 S30 SD 31	1	OR214	916	NoSurvey.pdf
160-005-440-4	BOND MARY M TRUSTEE	R13 T08 S30 SD 56	2.865	OR214	916	UNN-0137.pdf
160-005-440-9	BOND MARY M TRUSTEE	R13 T08 S30 SD 61	4.667	OR214	916	NoSurvey.pdf
160-005-441-1	DEVEREAUX MATTHEW	R13 T08 S30 SD 63	0.09	OR235	2956	UNN-0137.pdf
160-006-700-0	DOUGHTY BRUCE L & CYNTHIA K	R13 T08 S30 SD 8 EX CO	42	OR205	2303	NoSurvey.pdf
160-000-530-0	FULTON WILLIAM & DIANA	R13 T08 S30 SD 6 SURV1	7.4465	OR214	3419	UNN-0258.pdf
160-001-860-0	GARRETT THEODORE L & LISA J	R13 T08 S30 SD 28 SUR	0.97	OR226	937	NoSurvey.pdf
160-002-180-0	GLADDEN FAMILY LLC	R13 T08 S30 SD 16	32.175	OR155	299	NoSurvey.pdf
160-002-170-0	GLADDEN FAMILY LLC	R13 T08 S30 SD 12-20	5.863	OR155	299	NoSurvey.pdf
160-002-210-0	GLADDEN MERRILL L	R13 T08 S30 SD 15 EX C	3.5	OR155	299	NoSurvey.pdf
160-002-220-0	GLADDEN MERRILL L	R13 T08 S30 SD 1 EX CO	80	D.V 73	187	NoSurvey.pdf
160-004-620-0	HALES RICHARD A	R13 T08 S30 SD 42	0.658	OR227	2503	UNN-0217.pdf
160-004-630-0	HALES RICHARD A	R13 T08 S30 SD 43	0.3	OR227	2503	UNN-0217.pdf
160-003-110-0	KAMINSKI KENNETH JAMES & ANDRE	R13 T08 S30 SD 47	0.5	D.V 162	765	NoSurvey.pdf
160-005-440-8	KESSLER CHRIS A	R13 T08 S30 SD 60	0.012	OR112	98	UNN-0137.pdf
160-000-570-0	MITCHELL WILLIAM J	R13 T08 S30 SD 46	0.41	OR209	2043	UNN-0009.pdf
160-012-810-0	MITCHELL WILLIAM J	R13 T08 S30 SD 44	1.06	OR209	2043	UNN-0009.pdf
160-005-440-1	PIERCE RONALD L	R13 T08 S30 SD 53	1.413	OR187	343	UNN-0137.pdf
160-005-440-7	PIERCE RONALD L	R03 T08 S30 SD 59	2.004	D.V 78	398	UNN-0137.pdf
160-005-440-0	PIERCE RONALD LEE	R13 T08 S30 SD 27	1.997	OR78	398	UNN-0137.pdf
160-000-420-1	RADCLIFF KATHY L & BRIAN	R13 T08 S30 SD 52 SUR	1	D.V 173	614	NoSurvey.pdf
160-005-440-5	SANDLIN JOHNNY M, JOHNNY SANDLI	R13 T08 S30 SD 57	0.277	OR205	2941	UNN-0137.pdf
160-005-440-6	SANDLIN JOHNNY M, JOHNNY SANDLI	R13 T08 S30 SD 58	0.295	OR205	2941	UNN-0137.pdf
160-601-280-0	STATE OF OHIO	R13 T08 S30 LOT 24	8.3	D.V 94	441	NoSurvey.pdf
160-601-270-0	STATE OF OHIO	R13 T08 S30 LOT 23	4	D.V 94	441	NoSurvey.pdf
160-601-200-0	STATE OF OHIO	R13 T08 S30 LOT 1	25.47	D.V 94	441	NoSurvey.pdf
160-601-260-0	STATE OF OHIO	R13 T08 S30 LOT 22	31.36	D.V 94	460	NoSurvey.pdf
160-601-240-0	STATE OF OHIO	R13 T08 S30 LOT 10	24			NoSurvey.pdf
160-601-220-0	STATE OF OHIO	R13 T08 S30 LOT 3	80	D.V 94	460	NoSurvey.pdf
160-601-210-0	STATE OF OHIO	R13 T08 S30 LOT 2	78	D.V 94	460	NoSurvey.pdf
160-601-250-0	STATE OF OHIO	R13 T08 S30 LOT 18	2	D.V 94	460	NoSurvey.pdf
U/I	STATE OF OHIO		42.31	D.V 94	441	NoSurvey.pdf
U/I	STATE OF OHIO		20	D.V 94	441	NoSurvey.pdf
U/I	STATE OF OHIO		1.69	D.V 94	441	NoSurvey.pdf
U/I	STATE OF OHIO		12	D.V 94	411	NoSurvey.pdf

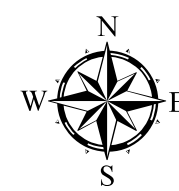

Boundaries	
	Hydro
	Section
	Roads
	Lot
	Township
	County
	Parcel
	ROW



Disclaimer: The information that these maps contains is for reference purposes only. Please bring any erros to the attention of the Engineer's Office staff. Thank you

Source: Morgan County Engineer's Office  
 Author: Marcia Wolfe  
 Date: 02/10/20

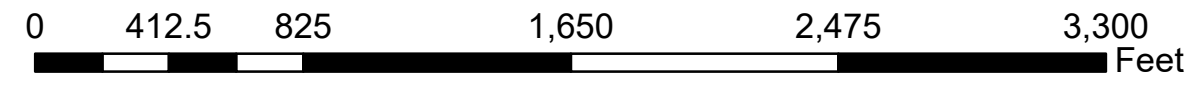

# UNION TOWNSHIP SECTION 30 R 13 TWP 8 MORGAN COUNTY, OHIO

PIN	Owner	LegalDescr	Acres	VOL	PAGE	Survey_Ref
160-006-450-0	SZABO RAE E	R13 T08 S30 SD 51	0.47	OR235	1605	UNN-0021.pdf
160-006-440-0	SZABO RAE E	R13 T08 S30 SD 45	1.467	OR235	1605	UNN-0302.pdf
160-005-441-3	TACKETT MICHAEL A & PATRICK A	R13 T08 S30 SD 65	0.398	D.V 206	433	UNN-0137.pdf
160-602-150-0	UNITED STATES OF AMERICA	R13 T08 S30 LOT 4 EX C	79	D.V 92	226	NoSurvey.pdf
160-602-160-0	UNITED STATES OF AMERICA	R13 T08 S30 LOT 5	2	D.V 92	226	NoSurvey.pdf
160-005-170-0	YOUNGERMAN RICHARD L	R13 T08 S30 SD 49	0.385	OR146	507	NoSurvey.pdf
160-005-190-0	YOUNGERMAN RICHARD L	R13 T08 S30 SD 50 EX C	0.93	OR139	734	NoSurvey.pdf
160-005-180-0	YOUNGERMAN RICHARD L	R13 T08 S30 SD 48	0.08	OR146	507	NoSurvey.pdf

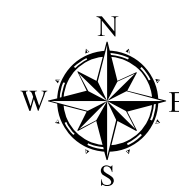
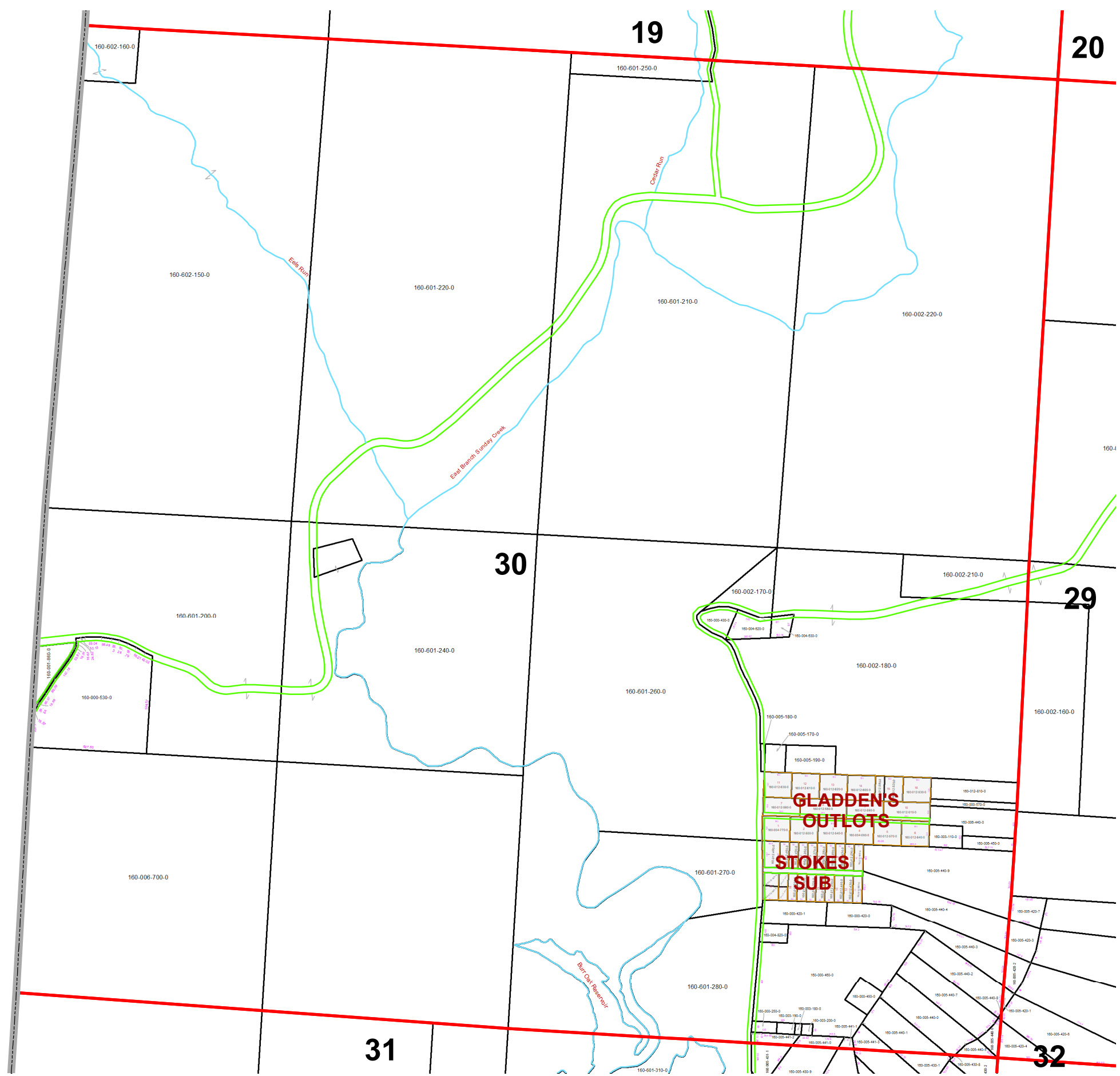

Boundaries	
	Hydro
	Section
	Roads
	Lot
	County
	Township
	Parcel
	ROW



Disclaimer: The information that these maps contains is for reference purposes only. Please bring any erros to the attention of the Engineer's Office staff. Thank you

Source: Morgan County Engineer's Office  
 Author: Marcia Wolfe  
 Date: 02/10/20

